

Swain's Lane, N6
 Approx. Gross Internal Area 790 Sq Ft - 73.39 Sq M

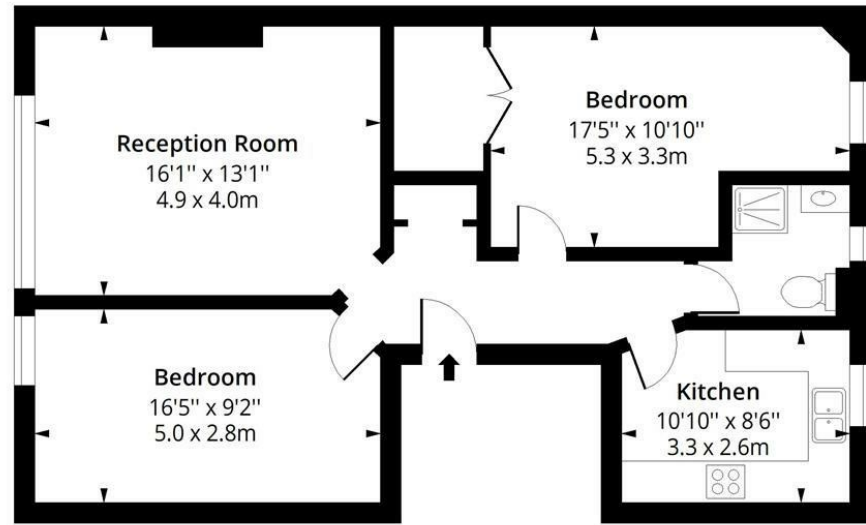

First Floor
 Floor Area 790 Sq Ft - 73.39 Sq M

Floor plan is for illustrative purposes only and is not to scale. Every attempt has been made to ensure the accuracy of the floor plan shown, however all measurements, fixtures, fittings and data shown are an approximate interpretation for illustrative purposes only.
 lpaplus.com

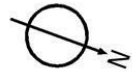

**Swains Lane
 N6 6QX
 £508 Per Week**

Newly refurbished throughout with a new kitchen and appliances is this very spacious **FIRST FLOOR TWO DOUBLE BEDROOM** flat located on Swains Lane and only a stone's throw from the wonderful open spaces of Parliament Hill Fields and the local shops and eateries located on and around Swains Lane. The flat is offered in excellent condition throughout with a new fitted kitchen and luxury shower room, carpeting and double glazing. The master bedroom features a walk in wardrobe.

Transport is provided by way of several bus routes, Kentish Town, Archway & Tufnell Park Underground (Northern Line) as well as Gospel Oak Overround.

AVAILABLE IMMEDIATELY - UNFURNISHED - EPC BAND C -TAX BAND D

19A SWAINS LANE HIGHGATE LONDON N6 6QX
 TELEPHONE 020 8341 9000 FACSIMILE 020 8341 9070
 EMAIL fitzroys-fitzroys@btinternet.com www.fitzroys.co.uk

JACK A. SHORN

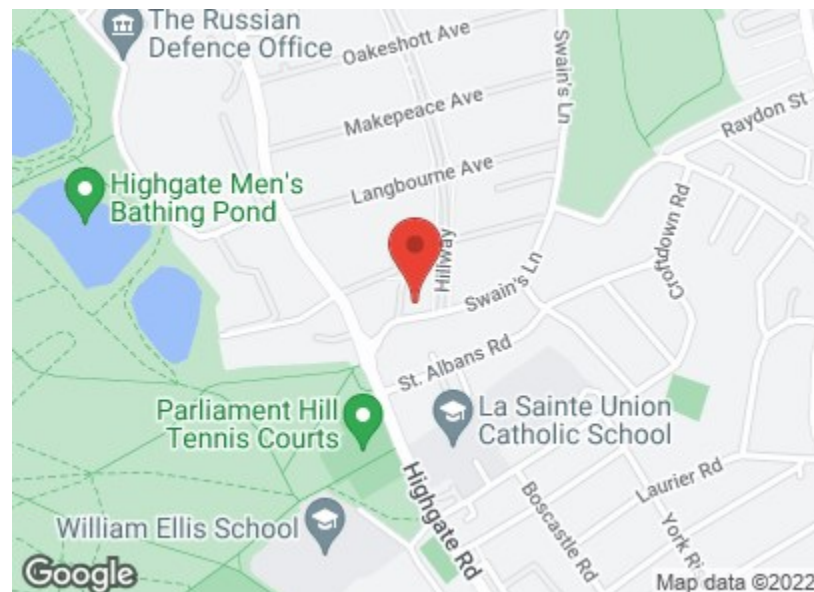

Energy Efficiency Rating	
Current	Potential
72	76

Environmental Impact (CO ₂) Rating	
Current	Potential
69	78

Service: It is not our company policy to test services and domestic appliances so we cannot verify that they are in working order. The buyer is advised to obtain verification from their solicitor or surveyor. These particulars are offered on the understanding that all negotiations are conducted through this company. Neither these particulars nor oral representation form part of any offer or contract and their accuracy cannot be guaranteed.

Swains Lane, London N6 6QX

